



BABYBELLE

smartly care



Please Save This Instruction Manual

Manufacturer : Tai Yu International Manufactory Limited
Address : South Seas Centre Tower II, 8/Floor,
Unit 804 & 805A 75 Mody Road, TST East,
Kowloon, Hong Kong

Warranty period :

You can help protect the environment! Please remember to respect the local regulations: hand in the non-working electrical equipments to an appropriate waste disposal center.



Breast Pump Instruction Manual

Model : BBP10
Input : DC6V 0.8A
Power : 2.4W

Breast Pump Instruction Manual

Model : BBP10

1. Parts Description

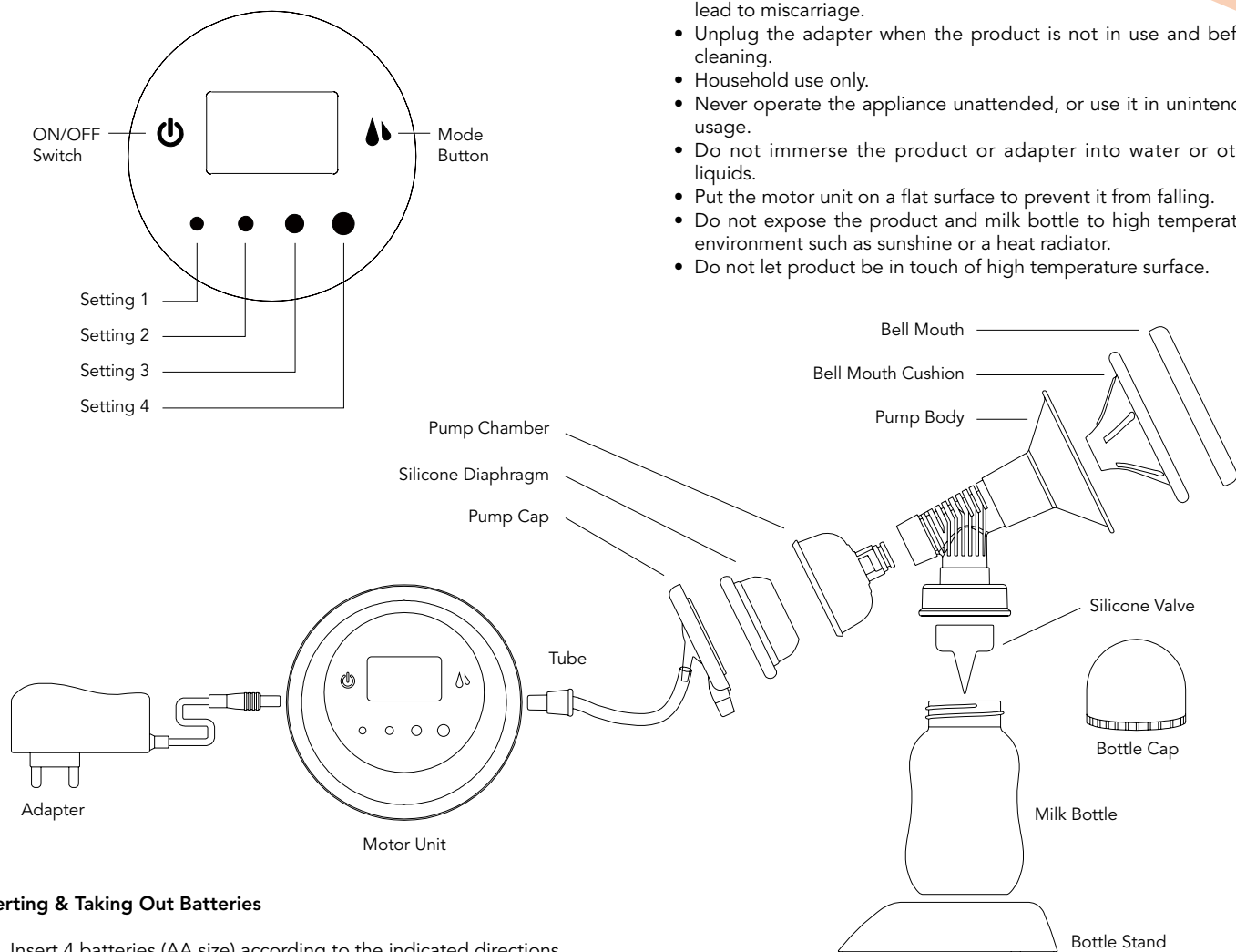

Inserting & Taking Out Batteries

1. Insert 4 batteries (AA size) according to the indicated directions.
2. Pull the tape to take out the batteries.

2. Safety Precautions

- Read this instruction manual carefully before using the product, and save it for future reference.
- Before plugging in the product adapter, check that the electrical rating shown on the rating plate corresponds with your household electricity supply.
- Only use the adapter provided with the product.
- This appliance is not intended for use by persons (including children) with reduced physical sensory or mental capabilities, or lack of experience and knowledge, unless they have given supervision or instruction concerning use of the appliance by a person responsible for their safety.
- Do not use appliance during the period of pregnancy as it may lead to miscarriage.
- Unplug the adapter when the product is not in use and before cleaning.
- Household use only.
- Never operate the appliance unattended, or use it in unintended usage.
- Do not immerse the product or adapter into water or other liquids.
- Put the motor unit on a flat surface to prevent it from falling.
- Do not expose the product and milk bottle to high temperature environment such as sunshine or a heat radiator.
- Do not let product be in touch of high temperature surface.

3. How to Use

Before the using the breast pump for the first time, please spend some time to go through this user manual, and save it for future reference.

This is designed for expressing milk in a safe and convenient way. The amount of expressed milk depends on the physical condition of the mother.

Expressing Mode		
Setting	Time (min)	Milk Vol. (ml)
1	10	82
2	10	100
3	10	120
4	10	150

Breast Pump:

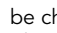
1. Clean and prepare properly before expressing milk.
2. Press and hold the ON/OFF button for 2s, the display flashes 3 times and shows the working time of the last operation. Then it will start working with the mode and speed of the previous operation (the memory feature only works when the power is not interrupted between operations).
3. During the operation, the mode can be swapped between Massage Mode  and Express Mode , and the speed can be changed from Setting 1 to Setting 4.
4. The speed setting should be adjusted until the user feels comfortable.
5. Special Note: The Bell Mouth Cushion should be tightly pressed against the breast to prevent the milk from leaking or poor suction performance.
6. Special Note: Do not directly pull out the breast pump from the breast when the product is operating in Express Mode. Switch off the product and use a finger to pry open the seal between the Bell Mouth Cushion and the breast.
7. Using for the first time, press and hold the ON/OFF button for 2s. The display flashes "00:00" 3 times, and the product starts working in Massage Mode and Setting 4. If no button is pressed within 2 minutes, the product will change to operate in Express Mode and Setting 2.
8. The product is powered by AA x 4 1.5V batteries, or the Adapter. If the Adapter is plugged in with the batteries inserted in the product, the default power source is the Adapter.
9. Special Note : Confirm the input voltage and the output voltage of the Adapter.
10. Please protect the environment. Do not expose batteries to sunshine. Never dispose batteries in fire or country side. Avoid using old and new batteries together. Follow the local legislation for environment protection. Dispose of the product and batteries at an appropriate waste treatment centre.

4. Cleaning & Maintenance

1. Warning : To avoid risk of short-circuit or electric shock, do not disassemble the Adapter and the breast pump or immerse it into water. Unplug the Adapter before cleaning.
2. Clean the surface of the breast pump with clean damp cloth.
3. Do not use detergent or corrosive agents to clean the breast pump and the Adapter.



BABYBELLE

smartly care



吸奶器使用說明書

型號：BBP10
電源：DC6V 0.8A
功率：2.4W

請保留此說明書備查

製造商：大宇國際電器有限公司
地址：香港九龍尖沙嘴東部麼地道 75 號，
南洋中心第二期 804 & 805A 室

吸奶器使用說明書

型號：BBP10

1. 吸奶器部件說明

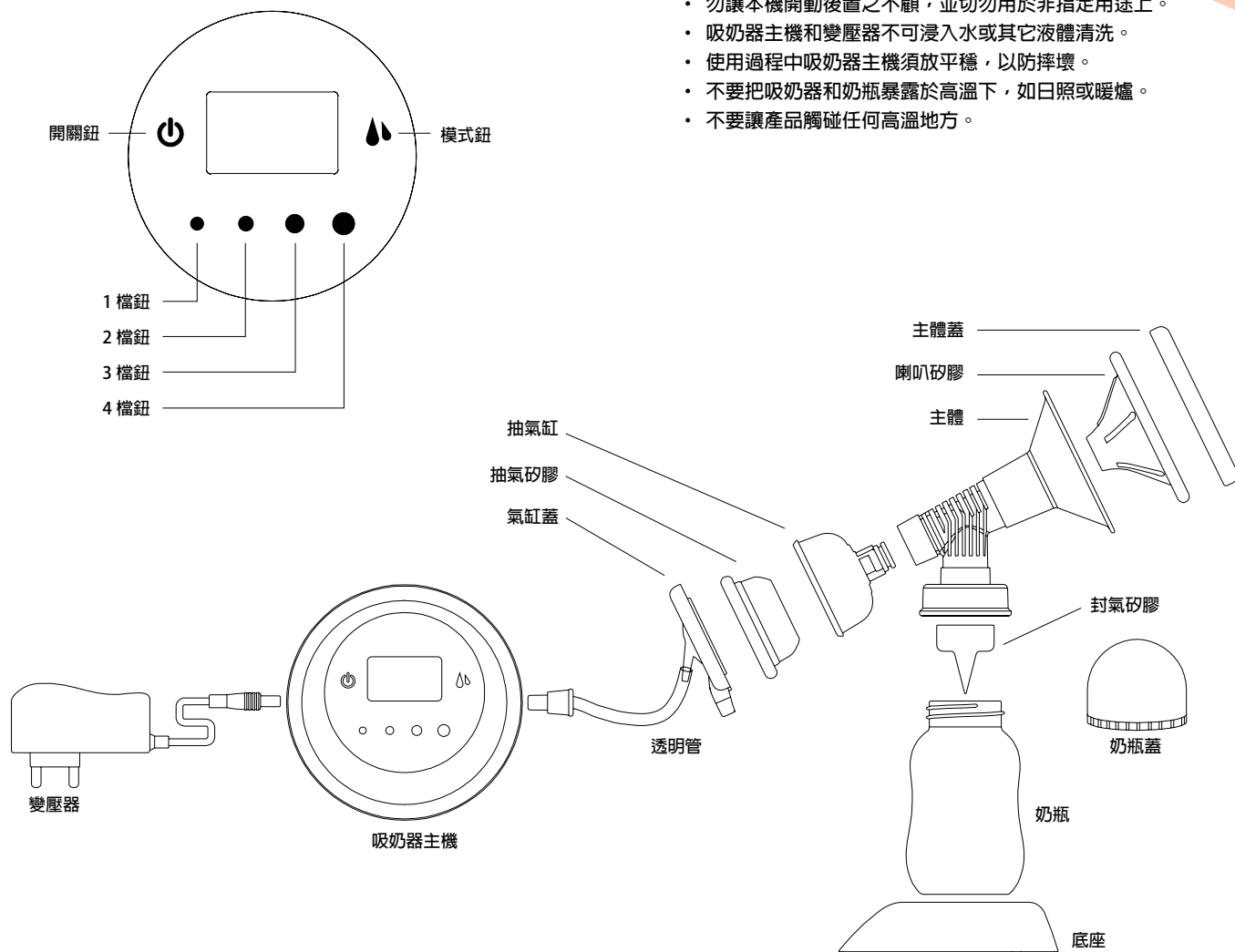

2. 安全注意事項

- 使用產品前請仔細閱讀本使用說明書，並請妥善保管本使用說明書。
- 插電前要確認變壓器標貼上輸入的電壓是否可用電源電壓。
- 僅使用產品配帶的變壓器。
- 本產品不預備給體弱，反應遲鈍或有精神障礙的人（包括兒童）使用，除非在對其負有安全責任的人員指導或幫助下安全使用。
- 懷孕期間切勿使用吸奶器，因為吸乳可能會導致流產。
- 在使用完畢後及清潔本機時，請拔掉插頭或電池，以免發生意外。
- 本產品僅適合家庭使用。
- 勿讓本機開動後置之不顧，並切勿用於非指定用途上。
- 吸奶器主機和變壓器不可浸入水或其它液體清洗。
- 使用過程中吸奶器主機須放平穩，以防摔壞。
- 不要把吸奶器和奶瓶暴露於高溫下，如日照或暖爐。
- 不要讓產品觸碰任何高溫地方。



3. 吸奶器使用說明

在第一次使用吸奶器之前，請花少許時間熟悉本說明書，並保留以便以後參考。

本產品以安全而方便快捷，為哺乳期母體吸出乳汁，備嬰兒食用或儲存。吸出的乳汁量和速度因人而異，下表數據僅供參考：

吸奶模式		
檔位	時間(分鐘)	乳汁(毫升)
1 檔	10 分鐘	82
2 檔	10 分鐘	100
3 檔	10 分鐘	120
4 檔	10 分鐘	150

吸奶器：

1. 先把吸奶前清潔和準備工作做好。
2. 開關鈕按住 2 秒，顯示螢幕閃爍 3 次上次工作時間，以上次停機的模式和檔位開始工作。（不斷電才能有記憶功能）
3. 產品工作時，可按模式鍵切換按摩模式  和吸奶模式 ，按檔位鍵可切換 1-4 檔，關機觸摸開關鈕。
4. 工作中可根據自身的適應度來調節檔位。
5. 特別注意：喇叭矽膠完全貼緊乳房，防止乳汁溢出或吸不出。
6. 特別注意：在真空條件下，切勿嘗試從乳房上取下吸奶器，請關閉產品並用手指打開乳房和吸奶器主體之間的密封。
7. 首次開機，長按開關鈕 2 秒，顯示螢幕 00:00 數字閃爍 3 次，產品以按摩模式 4 檔開始工作，2 分鐘內沒任何觸摸動作，產品自動切換成吸奶模式以 2 檔模式運行。
8. 產品可裝 4 粒 1.5V AA 電池或由變壓器供電，當產品有電池供電，再插入變壓器時，產品會默認使用變壓器為電源。
9. 特別注意：須查看變壓器的輸入電壓和輸出電壓標示。
10. 請注意保護環境，電池不能暴曬，不能投入火中或遺棄野外，不宜舊電池或不同種類電池混用，遵守當地環境法規，廢棄電器和電池請送往合適的廢棄物處理中心進行處理。

4. 清潔與保養

1. 警告：為防止意外，不要拆卸變壓器和吸奶器主機或把它浸入水中。開始清潔前要把變壓器插頭拔掉並取下電池。
2. 用乾淨的濕布清潔吸奶器的外表面。
3. 不能用洗潔精或帶腐蝕性物質來清潔吸奶器和變壓器。

5. 電池裝入和拆卸

1. 電池正負極須和符號相對應，4 粒電池串連。
2. 輕拉緞帶將電池取出。

請注意保護環境，遵守當地環境法規，廢棄電器請送往合適的廢棄物處理中心進行處理。

