

KNOWING YOUR THERMOMETER SET



- A. Pacifier (Model: BBA01)
- B. Pacifier Thermometer (Model: BBT02)
- C. Digital Thermometer (Model: BBT01)
- D. Storage Porch

SAFETY

READ ALL INSTRUCTIONS

- Store the thermometers out of reach of child.
- DO NOT allow child to take temperature unattended.
- DO NOT tie this thermometer around the child's neck, as it could strangle the child.
- Before each use of this thermometer, check the nipple of the pacifier for tears or cracks and pull it to ensure the nipple is attached to the shield firmly. DO NOT use it if loose nipple is found.
- Clean the thermometer before each use, wash the unit with mild soap and warm water, rinse well.
- DO NOT use this thermometers when the "bat" icon appears and flash on the displays. This is the battery low warning signal and the measurement will be inaccurate.
- DO NOT use boiling water or harsh chemicals to clean the thermometer.
- When measuring the temperature with the digital thermometer (C), DO NOT walk or run as the probe could present a hazard.
- DO NOT open the thermometer except for replacing the battery.
- Once temperature measuring is completed, the unit should be removed from the child immediately.
- The pacifier thermometer is NOT intended for use as a custom pacifier or teething instrument. Using it as regular pacifier or teething instrument reduces the useful life of this thermometer.
- If EPP displays and measurement is not attainable, the unit must be replaced.

THIS PRODUCT IS INTENDED FOR HOUSEHOLD USE ONLY

WHAT IS A "NORMAL" CHILD TEMPERATURE?

Although the generally accepted "normal" temperature for children is between 36.5°C (97.7°F) and 37.5°C (99.5°F). Temperature readings can vary and still may be considered "normal". Variations in temperature can be attributed to age, activities, time of days, etc. Our temperature is lower in the morning than in the afternoon. Other variations may be due to the location of the temperature reading, while the oral temperature follows the guidelines described in following sections, a rectal temperature is generally 0.5°C / 1.0°F higher. Conversely, an auxiliary (under the arm) temperature will be 0.5°C / 1.0°F lower. When reporting your child's temperature to the professional, state clearly the method of measuring used.

USE OF THE PACIFIER THERMOMETER

The most convenient way to measure your baby's temperature is using the pacifier thermometer. This is also the most comfortable method for the baby as it pacifies the baby with its special design.

- Remove the storage cover from the pacifier thermometer.
- Press the ON/OFF button to activate the thermometer. The display shows icons as per "Fig. A", followed with previous measured temperature with an "M" icon.

Fig. A



- The display will then be shown as "Fig.2" or "Fig.3" (depends on units set) with the measuring unit flashing;

Fig. B



Fig. C

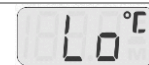

- Place the pacifier thermometer in the baby's mouth and leave it there until the

thermometer beeps. This usually takes 1-2 minutes.

- The display will now show the peak temperature with the °C/°F symbol.
- Remove the pacifier thermometer from baby's mouth.
- Press ON/OFF button to switch off the thermometer. This can extend the life of the battery and hence the life of the thermometer. The thermometer will switch off automatically after about 8 minutes.

CHECKING THE LAST TEMPERATURE TAKEN

- The last temperature is always stored in the memory automatically;
- The last temperature will be displayed on the display window when you switch on the thermometer again. The last temperature will show briefly for 1 second with the icon "M" shown on the bottom right hand corner. The last temperature will show up on the display after you hear the beep when you switch on the thermometer.

BATTERY LOW INDICATION

The battery in your digital pacifier thermometer has a long-life, which should last for around 2 to 3 years. When "bat" appears and flash on the right side of the display window indicates the battery is low. This means the thermometer has reached the end of its useful life, thus STOP using it immediately.

The pacifier (soother) thermometer is a sealed unit and therefore the whole unit must be replaced when the battery becomes low.

USE OF THE DIGITAL THERMOMETER

The pacifier thermometer is as accurate as the digital thermometer and it is easy for baby temperature measuring. However, rectal measuring is considered as more accurate measurement position for human body. The thermometer supplied in this set gives you an opportunity to the measured temperature by the using pacifier thermometer.

- Remove the storage cover from the digital thermometer. If available, use the special plastic hygiene covers to cover the tip of the thermometer (you can get it from most pharmacies)
- Press the ON/OFF button to activate the thermometer and the display shows icons as per "Fig. A", followed by previous measured temperature with an "M" icon. The display will then show as "Fig.2" or "Fig.3" (depending on units set) with the measuring unit flashing, this indicates that the thermometer is ready for taking temperature measurement;
- Have your baby lie stomach down on your lap.
- Lubricate the tip of the digital thermometer and around rectum with a water-soluble personal lubricant. DO NOT use petroleum jelly.
- Hold your baby still and gently insert the probe tip into rectum about ½ inches (about 1cm). If the baby is less than 6 months old, gently insert no more than ¼ inches to ½ inches into the rectum.
- DO NOT force the tip into the rectum if resistance is encountered.
- The peak temperature should be reached in approximately 10 seconds.
- Once the peak temperature is reached, the thermometer will beep and the display on the thermometer will show the highest measured temperature with the °F/°C symbol. (Note: In general, rectal temperature is 0.5°C / 1.0°F higher than oral temperature.)
- Press ON/OFF button to switch off the thermometer. This can extend the life of the battery and hence the life of the thermometer. The thermometer switches off automatically after about 8 minutes.

CHECKING THE LAST TEMPERATURE TAKEN

- The last temperature is always stored in the memory automatically;
- The last temperature will be displayed on the display window when you switch on the thermometer again. The last temperature will show briefly for 1 second with the icon "M" shown on the top right hand corner. It will show up on the display after you hear the beep when you switch on the thermometer.

USE WITH OLDER CHILDREN AND ADULTS

- The digital thermometer is also good for measuring older children and adults

temperature. Oral and underarm method can be used.

- For hygiene reason, if the thermometer has been used rectally without hygiene covers, DO NOT use it for oral measurements.

REPLACING THE BATTERY

The battery in your digital thermometer needs to be replaced when "—" appears on the right side of the display window. Replace the battery with a 1.5V, LR41 alkaline or SR41 silver oxide type or equivalent.

To replace the battery

- Remove the battery cover by turning it anti-clockwise with a coin.
- Take out the old battery from the thermometer and replace with the new one, but ensure the "+" pole (the flat surface) facing upward.
- Replace the battery cover and turning it clockwise with a coin and lock it into place.

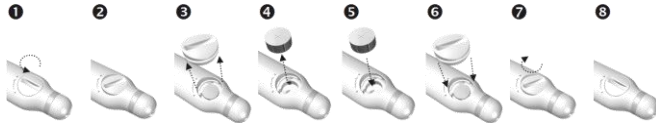

NOTE: It is extremely dangerous if button battery is swallowed.

Always use environmental friendly way to dispose batteries.

FEVER & NORMAL SIGNAL

- When the peak temperature stabilizes, the thermometer will beep. If the temperature $\geq 100^{\circ}\text{F}$ (37.8°C), the thermometer will give an alarm of 10 x 3 short beeps (**BIBIBI, BIBIBI, BIBIBI, BIBIBI**) in 10 seconds. This indicates a fever signal and you should consult your physician. On the other hand, if the temperature is $< 100^{\circ}\text{F}$ (37.8°C), the thermometer will give 10x1 long beeps (**BI, BI, BI**) in 10 seconds.
- Record the temperature and time after each measuring for reference. The reading will automatically be stored in the memory and shown on the display when you switch on the unit again next time;

TIPS FOR ACCURATE MEASURE

- Avoid drinking hot or cold liquids, exercising, smoking, or taking a bath or shower prior to a measuring. These activities will raise or lower the temperature readings when compared with the normal, average temperature.
- Refer to the instruction for different methods to get the most accurate measurement for the related method. If the tip of the thermometer is not placed to the proper position mentioned in the related section, then the temperature reading can vary.
- The beeps indicate the peak temperature has been reached, when the $^{\circ}\text{F}/^{\circ}\text{C}$ symbol stops flashing with a consistent temperature reading. It indicates the peak temperature has been reached as well.

CONVERSION BETWEEN $^{\circ}\text{F}$ & $^{\circ}\text{C}$

- Turn thermometer off and back on.
- Turning on the thermometer again, press and hold ON/OFF button for 2 seconds, the temperature unit $^{\circ}\text{F}$ & $^{\circ}\text{C}$ will change accordingly.
- Now the thermometer can be used to measure temperature in the unit that is shown on the bottom right hand corner of the display window.
- Repeat the above process to reverse the measurement unit again if desired.

GENERAL CARE

- The thermometers are precision instruments, please treat them with care.
- Only use them for human body temperature measuring.
- Do not store the unit where it will be exposed to direct sunlight, dust or humidity. Also AVOID extreme temperatures.
- Dropping or subjecting your thermometer to strong shocks should be avoided, as this may damage the unit.
- Do not use boiling water or harsh chemicals to clean the thermometer.
- Clean the thermometer before and after each use.

- Store the unit in the protective cover while not in use.

NOTE: Performance of the device may be degraded when operated outside of the stated temperature and humidity range; stored outside of stated temperature and humidity range; thermometer undergoes mechanical shock (drop); patient temperature is below ambient temperature.

CLEANING

Clean the thermometers after each use. Wipe the thermometer with a soft damp cloth. DO NOT wash in the dishwasher.

PRODUCT FEATURE & SPECIFICATION

Dimension (mm)	155(L) x 85(D) x 55(H) - pouch size
Weight	132 grams (with pouch)
Measuring time	90 seconds for BBT02; As short as 10 seconds for BBT01 rectal use
Measurement Range	32.0°C to 42.9°C/89.6°F to 109.2°F
Measurement units	Measure in Centigrade ($^{\circ}\text{C}$) and Fahrenheit ($^{\circ}\text{F}$)
Display Resolution	0.1 for both $^{\circ}\text{C}$ and $^{\circ}\text{F}$
Auto Off	Around 8 minutes
Accuracy	$\pm 0.2^{\circ}\text{F}$ for reading 95.9°F - 107.6°F ; $\pm 0.1^{\circ}\text{C}$ for reading 35.5°C - 42.0°C ; $\pm 0.4^{\circ}\text{C}$ or $\pm 0.2^{\circ}\text{C}$, outside the above ranges
Battery	LR41 or SR41 or equivalent
Battery Life	2-3 years (approximate 1500 temperatures)
Operating Condition	Temperature: 50°F to 104°F / 10°C to 55°C Relative Humidity: 15% to 95%
Storage Condition	Temperature: -13°F to 131°F (-25°C to 55°C) Relative Humidity: 15 to 95%
Other features	<ul style="list-style-type: none"> Thermometers set supplied with a traveling pouch, a digital thermometer, a pacifier thermometer, and a pacifier (same design of the pacifier thermometer for easy baby temperature measurement); Soft, flexible tip of the digital thermometer for added comfort and safety, ideal for children Lanyard for easy carrying and storage

SAVE THESE INSTRUCTIONS

Product complies with MDD93/42/EEC, EN12470-3 (2000), ASTM E1112-00 (2000),



Babybelle Ltd.
www.bb-babybelle.com



BABYBELLE

BABY THERMOMETER SET

Model: BBV01



INSTRUCTION MANUAL