

- Press the button for a short time, intermittently, and continue repeating this operation according to the type of food used and the consistency desired;
- Do not use the appliance in the absence of liquid or food which are too dry. This type of use may irreparably damage your appliance.
- Avoid using the device when not immersed in liquid or food.
- The hand mixer is fast and easy to use. Equipped with a handy measuring beaker, it can also be used directly in the saucepan. With the right blade it can blend and mix everything that's needed to make puree, mayonnaise, soup, sauces and desserts. It is important to remember not to use the device on dried food or when not immersed.

CHANGING BLADES

- Disconnect the power supply when changing blades.
- First place the key below the thread on the shaft then place the blade on the shaft and turn it clockwise to fit the blade and turn anti clockwise to remove it.
- Be cautious while handling blades as they are sharp and could hurt your hands. It is highly advised to use a cloth while changing blades.

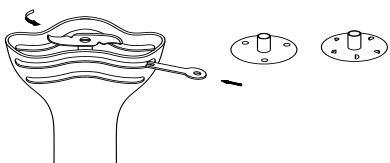

CARE & CLEANING

- Always switch off, unplug and allow the device to cool down before cleaning.
- Use a damp cloth to clean the appliance.
- The motor housing must not be immersed in water or placed in a dishwasher.
- Be cautious while washing the blades. These metal blades could hurt your hand. Same caution is to be applied while changing the blades.
- To avoid thermal shock, wait until the hand mixer has cooled down completely before washing the blade part in cold water.

SAVE THESE INSTRUCTION

For household use only.

CAUTION

This product is designed as an immersion hand mixer, any other type of use should be considered improper and therefore dangerous.

Correct Disposal of this product	
	<p>This marking indicates that this product should not be disposed with other household wastes. To prevent possible harm to the environment or human health from uncontrolled waste disposal, recycle it responsibly to promote the sustainable reuse of material resources. To return your used device, please use the return and collection systems or contact the retailer where the product was purchased.</p>



BABYBELLE

HAND MIXER Model No.: BBC05

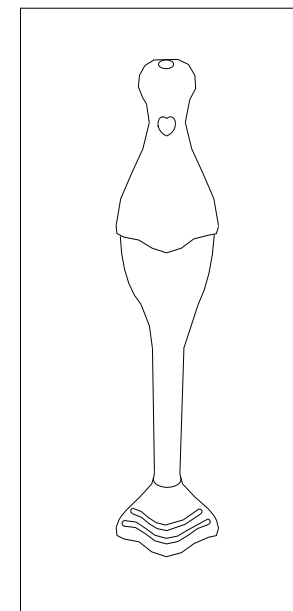

**VERSATILE
HANDY
POWERFUL
SO EASY SO CUTE**

SPECIFICATION

Electrical Rating	220-240V ~ 50Hz
Power	150W

SAFETY SAFEGUARDS

- The appliance is designed to work on an alternative current only.
- Before check that your voltage corresponds to the voltage indicated on the appliance.
- The appliance is connected to an alternating current with the same voltage as shown on the appliance;
- The supply cord should be completely unwound and should be in perfect condition;
- If the plug on the appliance does not fit the socket, have the plug replaced with the plug which is suitable for the voltage absorbed by the appliance;
- If the supply cord is damaged, it must be replaced by the manufacturer, its service agent or similarly qualified persons in order to avoid a hazard.
- This appliance is not intended for use by persons (including children) with reduced physical, sensory or mental capabilities, or lack of experience and knowledge, unless they have been given supervision or instruction concerning use of the appliance by a person responsible for their safety.
- Children should be supervised to ensure that they do not play with appliance.
- Switch off the appliance and disconnect from the supply before changing accessories or approaching parts that move in use.
- Care is needed when handling cutting blade, especially when removing the blade from the bowl, emptying the bowl

and during cleaning.

ADDITIONAL SAFETY MEASURES RECOMMENDED

- Do not leave packaging components (plastic bags, cardboard, polystyrene, etc), within reach of children as they could be dangerous;
- Do not pull either the supply cord or the appliance itself in order to disconnect the plug from the socket;
- Do not use the appliance when empty;
- Do not touch the appliance and do not connect or disconnect the plug if your hand and/ or feet are wet;
- Disconnect the plug from the socket when not using the appliance.
- Do not put the appliance away until it has cooled down completely.
- Before operating the hand mixer, immerse the blade part of the appliance into the container with the ingredients.
- Do not immerse the appliance into the saucepan when it is on the heat or when the contents are boiling.
- **Before removing the hand mixer from the container with the food, wait a few seconds until the blade has come to a complete halt**

KNOW YOUR HAND MIXER

- For Type, Power and Voltage, see the data shown on the appliance.
- Three kinds of stainless steel blades are suitable for all sorts of food.
- The appliance may be used for a maximum of one-minute (KB 1 minute).
- The appliance should be left to cool for three minutes after each use.

- A longer break of 30 minutes is necessary after such five working circles in order to allow the appliances to cool down.

DESCRIPTION (Fig.1)

- 1) Supply cord
- 2) "On" button
- 3) Motor housing
- 4) Blade (a) (b) (c)
- 5) Measuring beaker (Capacity 550cc, 160z.)
- 6) Key

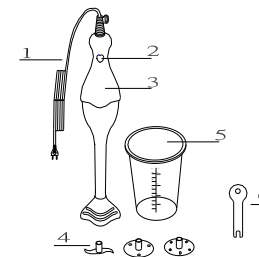

Fig.1

OPERATION INSTRUCTION

1. Select a suitable blade to blend and mix the food to work perfectly. Use a cloth to change the blade.
2. Place the hand mixer into the measuring beaker (5) as shown in (Fig.2). or into the saucepan
3. Press the "on" button.
4. After using, not remove the hand mixer from the food container immediately, wait a few seconds until the blade has come to complete halt.



Fig.2

For better results

- Blade (a) chops vegetable, salads, baby-food, raw fruit, dough and berries.
Blade (b) blend sauces, milk shakes, frothy creams.
- Blade (c) whisking up creaming potatoes, mayonnaise, cocktails and shakes.