

KNOW YOUR STEAM STERILIZER

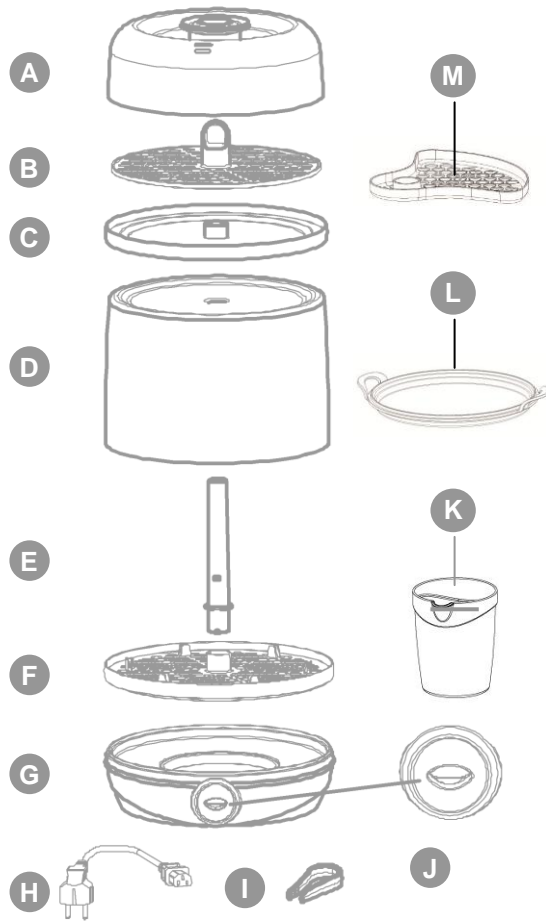

- A. Lid
- B. Top Rack
- C. Top Tray
- D. Sterilizer Body
- E. Central Stem
- F. Bottom Rack
- G. Sterilizer Base
- H. Power cord
- I. Tongs
- J. Start Button with Power Indicator
- K. Measuring Cup
- L. Microwave Tray
- M. Microwave Rack

USE OF THE STERILIZER

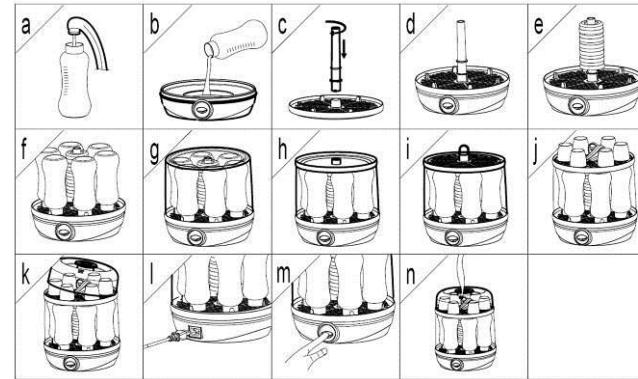

DIFFERENT STERILIZER CONFIGURATION



Milk bottle sterilizing configuration



Breast Pump sterilizing configuration

SAFETY INFORMATION

When using electrical appliances, basic safety precautions should always be followed including the following:

READ ALL INSTRUCTIONS

- Always use the steam sterilizer on a flat surface.
- DO NOT expose the sterilizer to source of heat such as a radiator or sun shining through a window.
- To protect against risk of electrical shock, NEVER put sterilizer power base in water or other liquid. Clean the sterilizer with a dry cloth.
- Close supervision is necessary when any appliance is used by or near children or incapacitated persons.
- NEVER use detergent or corrosive substances to clean the steam sterilizer.
- NEVER use the unit without water.
- Please always fill the recommend amount of water or otherwise it may alter the sterilization quality.
- The sterilizer will stop automatically with the power indicated turned off in case of lack of water. In this case, fill the unit with recommended amount of cold water and run a complete sterilizing cycle again to ensure proper sterilizing is achieved.
- Unplug the sterilizer when not in use, before cleaning or changing accessories.
- DO NOT operate the sterilizer with a damaged cord, plug or after appliance malfunctions, or is dropped or damaged in any manner. Return appliance to the nearest Authorized Service Center for examination, repair or electrical or mechanical adjustment.
- Any servicing should be performed by an authorized service representative.
- DO NOT unplug the product during the sterilizing cycle as it will affect the sterilization quality of the cycle. In case of mistakenly unplug of the product during the sterilizing cycle, pour the remaining water, refill with the recommended amount of cold water and plug the power plug to the wall socket again. A new cycle should restart again automatically with the indication light turned on once the power cord is connected to the socket.
- Use of any attachments, not recommended as it may cause fire, electric shock or injury.

- DO NOT use outdoors.
- DO NOT let the cord hang over edge of table or counter.
- DO NOT let the cord contact any hot surface.
-  DO NOT immerse in water.
- This appliance is not intended for use by persons (including children) with reduced physical, sensory or mental capabilities, or lack of experience and knowledge, unless they have been given supervision or instruction concerning use of the appliance by a person responsible for their safety.
- Children should be supervised to ensure that they do not play with the appliance.
- Ensure nothing is rested on the heating element surface (the stainless steel surface on the base) of the unit before starts the sterilizing process.
- When in use, the sterilizer contains BOILING WATER.HOT STEAM will escapes from the vent in the lid.
- Take care when opening as steam can burn.
- NEVER open the unit when in use, as it affects the sterilization quality.
- NEVER place any items on top of the sterilizer.
- Stop the sterilizer during the cycle only when absolute needed, unplug the unit from the mains.

THIS PRODUCT IS INTENDED FOR HOUSEHOLD USE ONLY

BEFORE PLUGGING IN THE STERILIZER

DO NOT plug the appliance in before checking that the voltage indicated on the rating plate is the same as the electrical supply voltage.

The wires in the flex are colored as follows:

Blue = N (Neutral) Brown = L (Live) Green / Yellow = E (Earth)

WARNING

The lead is fitted with a non-rewireable plug.In the event that the plug is not fit for the power sockets in place, a suitable adaptor must be used.The adaptor must be earthed with the plug type on the lead.

BEFORE THE FIRST USE OF YOUR STERILIZER

- Unpack all parts of the sterilizer from the packing and remove all plastic bags.
- Prior to first use, wash lid, top rack, top tray, sterilizer body, central steam, bottom rack and tongs,
- After washing, measure 200ml of tap water with the milk bottle and pour it to the sterilizer base unit.
- Now fix the central steam to the bottom tray and then place them on the base unit, then place the sterilizer body, top tray, top rack and lid in sequence as per the diagram.The tongs should place on the top rack before closing it with the lid.
- Connect the power plug to the main supply.
- Press the "Start" button downward and the start button will light up to indicate that the sterilizer process started.
- When the cycle is completed (after approximately of 8 minutes), the power indication light will turn off and the unit will switched off automatically.
- To avoid risk of burning, leave the sterilizer to cool down for 2 minutes.
- The unit still hot after 2 minutes of cooling.All parts must be handled with care to prevent burning.
- Remove the lid, racks, and trays from the sterilizer base and pour away any remain water in the base. Wipe all parts with clean dry clothes.

STERILIZE 6 SETS OF FEEDING BOTTLES

- Before sterilizing, disassemble all parts of the bottle and wash them with mild soapy water and rinse.
- Refer to the "USE OF YOUR STERILIZER" diagram.
- Measure exactly 200ml of water with the measuring cup or a milk bottle (a) and then pour the water in the sterilizer base (b).
- Place the bottom rack with the central stem fixed (c) onto the sterilizer base (d).
- Place the screw rings to the central stem (e);

- Load the milk bottle body with neck downward and slot it to the location ribs provided on the bottom rack (f).
- Cover the bottom rack with the sterilizer body (g);
- Place the top tray and the top rack on the sterilizer body (h & i).
- Place the teats, caps, and tongs on the top rack (j).
- Cover the top rack with the lid (k).
- Connect the power plug to the main supply.
- Press the "Start" button (m) downward and the start button will light up to indicate sterilizer process started (n).
- When the cycle completed (after approximately of 8 minutes), the power indication light will turn off and the unit will switched off automatically.
- To avoid any risk of burning when handling, leave the sterilizer to cool for 2 minutes.
- However the unit and all sterilizer items are still relatively hot after 2 minutes of cooling time and therefore special care is needed when handle any item after just 2 minutes of cooling time.
- It is recommended to leave the unit for half an hour after the cycle completed. This will allow the unit and all sterilizer items cool down to a safe to touch temperature.

USING THE STERIALIZED ITEMS

- Wash your hands before removing any sterilized items.
- Now you can open the sterilizer lid and place it upside down on the bench.
- Remove the top tray (with the top rack and all sterilized accessories) from the sterilizer and place it on the upside down lid.
- Remove the sterilizer body to access the milk bottles and screw rings.
- Now you can assemble the milk bottle with the help of using the tongs.The tongs are for removing small items and also for pulling the sterilized teats through the screw ring.If needed, shake excess water from items before assembling.

STERILIZE THE BREAST PUMP

- This sterilizer is specially designed for easy sterilizing the breast pump parts by sample using the upper parts of the sterilizer with the base.
- Add 200ml of water to the sterilizer base.
- Place the top rack on the sterilizer base directly.
- Slot the breast pump shield to the appropriate slot provided on the top rack and arrange other breast pump parts onto the top rack.
- Other processes are identical to the standard bottle sterilizing process.

CLEANING

- Switch off, unplug and disassemble before cleaning.
- Do not let the power base, flex or plug get wet.
- Wipe power base with damp cloth, then dry, avoiding the use of abrasive detergents.
- Do not use bleach or chemical sterilizing solution/tablets in your steam sterilizer
- Never immerse the base unit into water.
- Before plugging the sterilizer again to the mains outlet make sure the base unit is thoroughly dry.

DE-SCALE YOUR STERILIZER

- After each use, pour away any remaining water from the sterilizer base.
- Using filtered water with your sterilizer can reduce lime scale build up and maintain best performance of the unit. You should de-scale your sterilizer every 4 weeks to ensure it work efficiently as scale may affect the operation of the sterilizer.
- To de-scale your sterilizer, mix one sachet of citric acid (10gms) with 200ml of water. Pour the mixture into the sterilizer base, do not put anything sterilizer part on the base and switch it on for around 1 minute and then switch off and leave it with the warm mixture for 30 minutes. Drain and rinse out sterilizer.Run a full cycle with only sterilizer lid on with 200 ml water. Wipe out the sterilizer after being emptied and it is now ready for use again.

SERVICING AND CUSTOMER CARE

- If the cord is damaged it must, for safety reasons, be replaced by an Authorized Service Center.
- If the sterilizer fails to operate, unplug the unit for 15 minutes, plug in and try again. If problems persist, check the trouble shooting section. If problem still persist after checking with the trouble shooting section, then contact Authorized Service Center.

TROUBLE SHOOTING

Sterilizer not working at all	<ul style="list-style-type: none"> • Check the power plug is connected to the main. • Check fuse in the plug if there is any.(uk only)
Bottle with marks after sterilizing	Sterilizer needs de-scaling. Refer to the de-scale your sterilizer section.
Power indicator away turned on once connected to the main	The switch of this unit is designed for "switch on" function only and it is not possible to switch off the unit manually after the cycle is started.The special "switch on" only switch is specially designed to prevent accidental interruption at the middle of an operation cycle. Power indicator turned on once unit is connected to the main indicates the switch of the unit is already at the "switched on" stage.To gain a "switch off" stage, please let the unit run a cycle without water and unit will turn off within a minute.
Unit cannot switch off	As per the above point, the unit does not have a manual switch off function.If turning off the unit is really necessary, unplug it from the main. Note: The unit will turn on again immediately once the unit is connected to the main again since the switch is still at "switched on" stage.
Cannot switch on the unit	The unit will need cool down for 15 minutes before a new cycle can start.

SAVE THESE INSTRUCTIONS

Environment friendly disposal

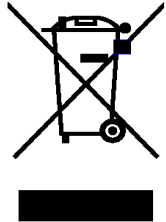

You can help protect the environment!
Please remember to respect the local regulations: hand in the non-working electrical equipments to an appropriate waste disposal center.



Tai Yu International Mfy. Ltd.
South Seas Center, Tower II, 8/F1., Unit 804 & 805A, 75 Mody Road, TST East, Kowloon, Hong Kong.



BABYBELLE

Electrical Steam Sterilizer Model:BBS04



INSTRUCTIONAL MANUAL

Voltage: 220-240V ~ 50-60Hz
Wattage: 830-980W
Capacity: 6 sets of baby bottle