

KNOW YOUR STEAM STERILIZER

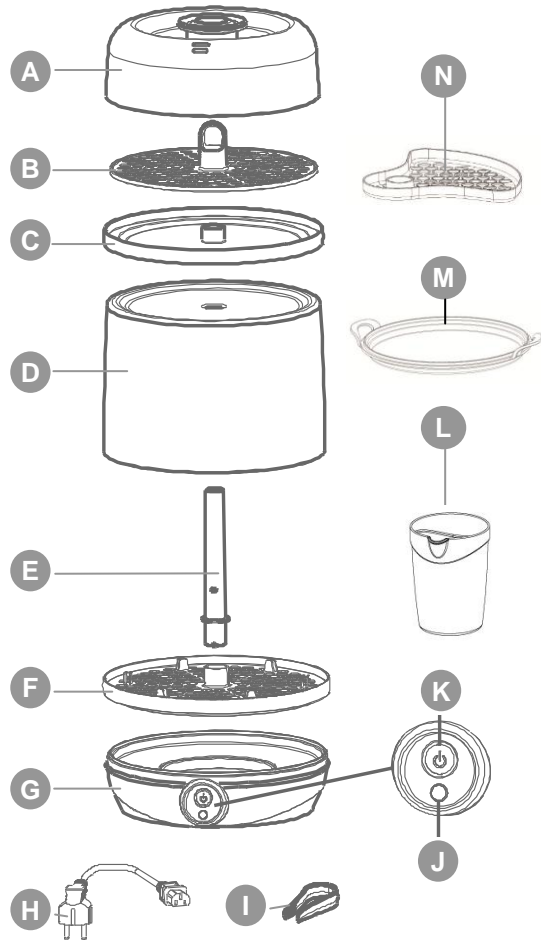

- A. Lid
- B. Top Rack
- C. Top tray
- D. Sterilizer Body
- E. Central Stem
- F. Bottom Rack
- G. Sterilizer Base
- H. Power cord
- I. Tongs
- J. Start/Stop Button
- K. Display
- L. Measuring cup
- M. Microwave Tray
- N. Microwave Rack

DISPLAY PANEL GUIDE

When the sterilizer proceeds through the cycle, the panel will show the following display to indicate the progress.

Just connected

When you just connect the unit to the mains, the display will show a red start/stop icon and a white ring for 1 second with a beep



Standby

The red start/stop icon stay means the sterilizer is plugged in and ready for use



Sterilizer Heating up

When you press the start/stop button, the sterilizer will beep once and the start/stop icon change to red with the white ring starting to rotate as per this pattern to indicate water is being heated



Sterilizing in progress

When water is boiled, the sterilizing process will start with the white ring rotatory with this new pattern



Cooling

Lights will rotate like this pattern when the sterilizing process completed. The sterilizing process is completed but the parts and sterilized items are still hot to handle.

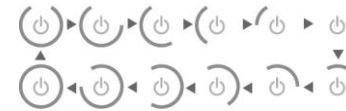

After cooling

When cooling stage is completed the start/stop icon will turn to green color with 3 beeps to indicate the part and items are ready for the user to handle. Item will stay sterilized for up to 3 hours, provided the sterilizer is not opened.

Up to 3 hours remaining



Up to 2 hours remaining



After 3 hours the start/stop icon will flash red (continuously until user reset it). This signal indicates items in the sterilizer need to be sterilized again before use

Up to 1 hour remaining



Warning (continue until reset by user)
Need to completely restart the sterilizer process.



also beep for ten seconds

USE OF YOUR STERILIZER

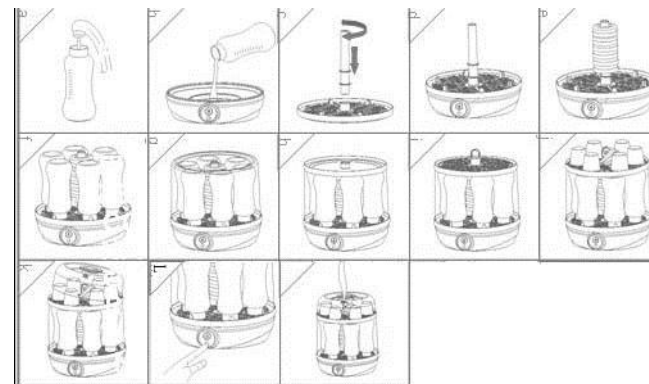

SAFETY INFORMATION

When using electrical appliances, basic safety precautions should always be followed including the following:

READ ALL INSTRUCTIONS

- Always use the steam sterilizer on a flat surface.
- DO NOT expose the sterilizer to source of heat such as radiator or sun shining through a window.
- To protect against risk of electrical shock, NEVER put sterilizer power base in water or other liquids. Clean the sterilizer with damp cloth, then let it dry completely.
- Close supervision is necessary when any appliance is used near children or incapacitated persons.
- NEVER use detergent or corrosive substances to clean the steam sterilizer.
- NEVER use the appliance without water.
- The sterilizer will stop automatically with a warning signal in case of lack of water. In such case, please run a complete sterilizing cycle again to ensure proper sterilizing is achieved.
- Please always fill the recommend amount of water or it may alter the sterilization quality.
- Unplug the sterilizer from outlet when not in use, before cleaning or changing accessories.
- DO NOT operate the sterilizer with a damaged cord or plug or after appliance malfunctions, or is dropped or damaged in any manner. Return the appliance to the nearest Authorized Service Center for examination, repair or electrical or mechanical adjustment.
- Any servicing should be performed by an authorized service representative.
- NEVER unplug the product during the sterilizing cycle or otherwise it will reset the sterilizing cycle. In case of mistakenly unplugging of the product during the sterilizing cycle, you need to restart the sterilizing cycle completely again to ensure a correct sterilizing quality can be achieved.
- Use of any attachments is not recommended as it may cause fire, electric shock or injury.
- DO NOT use outdoors.
- DO NOT let the cord hang over the edge of the table or counter.
- DO NOT let cord contact any hot surface.
-  DO NOT immerse in water.
- This appliance is not intended for use by persons (including children) with reduced physical, sensory or mental capabilities, or lack of experience and knowledge, unless they have been given supervision or instruction concerning use of the appliance by a person responsible for their safety.
- Children should be supervised to ensure that they do not play with the appliance.
- Ensure nothing is rested on the heating element surface (the stainless steel surface on the base) before starting the sterilizing process.
- When in use, the sterilizer contains boiling water. Hot steam will escape from the vents of the lid.
- Take care when opening the lid as steam can burn.
- NEVER open the unit when in use.
- NEVER place any item on top of the sterilizer.
- Stop the sterilizer during the sterilization cycle only when absolutely needed by pressing the start/stop button or unplug from the mains.

THIS PRODUCT IS INTENDED FOR HOUSEHOLD USE ONLY

BEFORE PLUGGING THE STERILIZER

DO NOT plug the appliance in before checking what the voltage indicated on the rating plate is the same as the electrical supply voltage.

UK ONLY The wires in the cord are colored as follows:

Blue = Neutral Brown = Live Green / Yellow = Earth

BEFORE THE FIRST USE OF YOUR STERILIZER

(Refer to the Display Panel Guide for the operation status)

- Unpack all parts of the sterilizer from the packing and remove all plastic bags.
- Prior to first use, wash lid, top rack, top tray, sterilizer body, central stem, bottom rack, measuring cup and tongs.
- After washing, measure 200ml of tap water with the milk bottle or measuring cup and pour it to the sterilizer base unit.
- Now fix the central stem to the bottom tray and then place them on the base unit, then place the sterilizer body, top tray, top rack and lid in sequence as per the diagram. The tongs should place on the top rack before closing it with the lid.
- Connect the the plug into the mains supply. The start/stop "⏻" icon on the panel will light up in red color.
- Press and hold the start/stop button for 1 second to allow the sterilizer to progress through a cycle until the "⏻" icon turn to green color.
- Remove the lid, racks, and trays from the sterilizer base and pour away any remain water in the base. Wipe all parts with clean dry clothes.

STERILIZE 6 SETS OF MILK BOTTLES

- Before sterilizing, disassemble all parts of the bottle and wash them with mild soapy water and rinse.
- Measure 200ml of water with the measuring cup or a milk bottle (a) and then pour the water in the sterilizer base (b).
- Place the bottom rack with the central stem fixed (c) onto the sterilizer base (d).
- Place the screw rings to the central stem (e);
- Load the milk bottle body with neck downwards and slot it to the location ribs provided on the bottom rack (f).
- Cover the bottom rack with the sterilizer body (g);
- Place the top tray and the top rack on the sterilizer body (h & i).
- Place the teats, caps, and tongs onto the top rack (j).
- Cover the top rack with the lid (k).
- Connect the plug into the mains supply .
- Push the start/stop button (l) to start the sterilizing cycle with detail progress as per the display panel guide.
- This product is specially designed with a cooling stage to ensure sterilizer parts, and sterilizing item are cool down to a temperature that is safe to touch. The change of the "⏻" icon from red to green color indicates the cooling process is completed.

USING THE STERILIZED ITEMS

- Wash your hands before removing the sterilized items.
- Now you can open the sterilizer lid and place it upside down on the bench.
- Remove the top tray (with the top rack and all accessories) from the sterilizer and place it on the upside down lid.
- Remove the sterilizer body to access the milk bottles and screw rings.
- Now you can assemble the milk bottle with the help of using the tongs. Tongs is for remove small items and also for removing the sterilized teats through the screw ring. If needed, shake excess water from items before assembling.
- Items will remain sterilized for 3 hours provided the sterilizer lid keep not open after the sterilizing cycle. The stable green "⏻" indicate these "keep sterilized stage" provided that you did not push the start/start button to reset sterilizer.
- After 3 hours, the sterilizer will beep for 10 times and the "⏻" icon will change to flash in red. The "⏻" change to flashing in red color indicates the sterilized item is no good for use anymore and a new complete sterilizing cycle is needed before using any item in the sterilizer.

STERILIZER CONFIGURATION



Milk bottle sterilizing configuration



Breast Pump sterilizing configuration

STERILIZING BREAST PUMPS

- This sterilizer is specially designed for the easy sterilizing of breast pump parts by just using the upper parts of the sterilizer with the base.
- Add 200ml of water to the sterilizer base.
- Place the top rack on the sterilizer base directly.
- Slot the breast pump to the appropriate slot provided on the top rack and arrange other breast pump parts onto the top rack.
- Other processes are identical to the standard bottle sterilizing process.

- Switch off, unplug and disassemble before cleaning.
- Do not let the power base, cord or plug get wet.
- Wipe power base with damp cloth, then dry, avoiding the use of abrasive detergents.
- Do not use bleach or chemical sterilizing solution/tablets in your steam sterilizer
- Never immerse the base unit into water.
- Before plugging the sterilizer again to the mains, make sure the base unit is thoroughly dry.

DE-SCALE YOUR STERILIZER

- After each use, pour away any remaining water from the sterilizer base.
- Using filtered water with your sterilizer can reduce lime scale build up. You should de-scale your sterilizer every 4 weeks to ensure it work efficiently otherwise may it affect the operation of the sterilizer.
- To de-scale your sterilizer, mix one sachet of citric acid (10gms) with 200ml of water. Pour the mixture into the sterilizer base, do not put anything sterilizer part on the base and switch it on for around 1 minute and then switch off and leave it with the warm mixture for 30 minutes. Drain and rinse out sterilizer. Run a full cycle with only the sterilizer lid on with 200 ml water. Wipe out the sterilizer being emptied and it is now ready for use again.

SERVICE AND CUSTOMER CARE

- If the cord is damaged it must, for safety reasons, be replaced by an Authorized Service Center.
- If the sterilizer fails to operate, unplug the unit for 15 minutes, plug in and try again. If problems persist, check the trouble shooting section. If problem still persist after checking with the trouble shooting section, then contact Authorized Service Center.

TROUBLE SHOOTING

Sterilizer not working at all	Check that the sterilizer is plugged to the main supply. Check fuse in the plug if there is any.
Bottle with marks after sterilizing	Sterilizer needs de-scaling. Refer to the " DE-SCALE YOUR STERILIZER" section
"⊕" icon on display panel flash between red and green continuously	Not enough water or not water is placed in sterilizer. Switch off, remove water, replace with 150ml of water and restart the cycle; Or too much scale is built up on the stainless steel surface of the heating element. De-scale must carried out immediately. Details refer to "DE-SCALE YOUR STERILIZER" section.
"⊕" icon continuously flashed between red and green and the start/stop button cannot reset the sterilizer.	The internal dry boil protecting device is not reset yet. In this case, don't use the item in the sterilizer and the sterilizing cycle "MUST" restart completely. You need to remove any remaining water and replace with new water before starting the new cycle. If the sterilizer still not able to restart, then unplug the unit, wait for 15 minutes, plug in and retry.

SAVE THESE INSTRUCTIONS

Environment friendly disposal



You can help protect the environment!
Please remember to respect the local regulations: hand in the non-working electrical equipments to an appropriate waste disposal center.



Tai Yu International Mfy. Ltd.
South Seas Center, Tower II, 8/F1., Unit 804 & 805A, 75 Mody Road, TST East, Kowloon, Hong Kong.



BABYBELLE

Electronic Steam Sterilizer BBS03



INSTRUCTIONAL MANUAL

Voltage: 220-240V ~ 50-60Hz
Wattage: 1180-1400W
Capacity: 6 sets of baby bottles